

INSTALLATION INSTRUCTION

Cigular Slab Bearing EcoLine 2.0

Preparation before installation



Please read the document carefully and completely, before you start the installation. The support surfaces must be flat, clean, dry and free of grease. Burrs must be removed and holes closed. Cigular EcoLine slab bearings are self-adhesive on the underside and thus do not need to be secured separately in windy weather.

1. Cigular slab bearing EcoLine 2.0 in condition as delivered

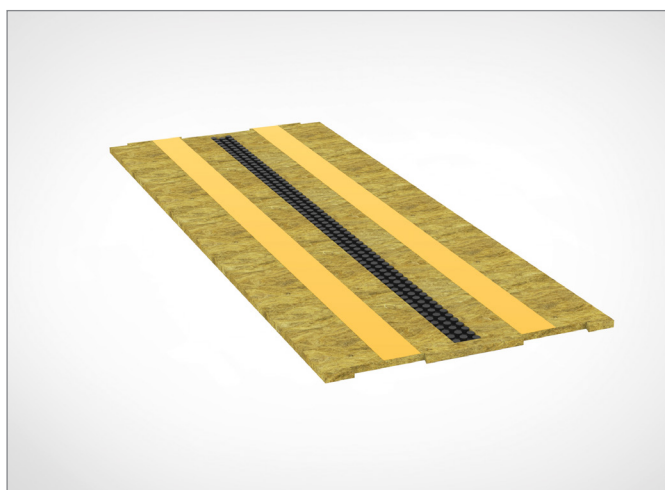

2. Remove the protective film before use



3. Positioning of the slab bearing



4. Easy connection with dovetail system

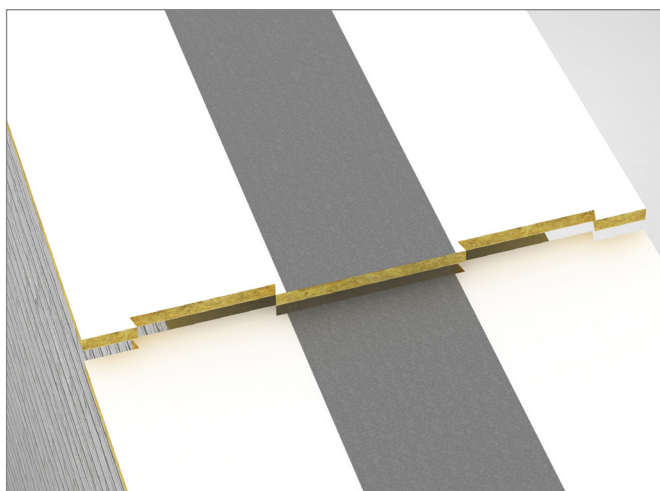



5. Alignment on the masonry

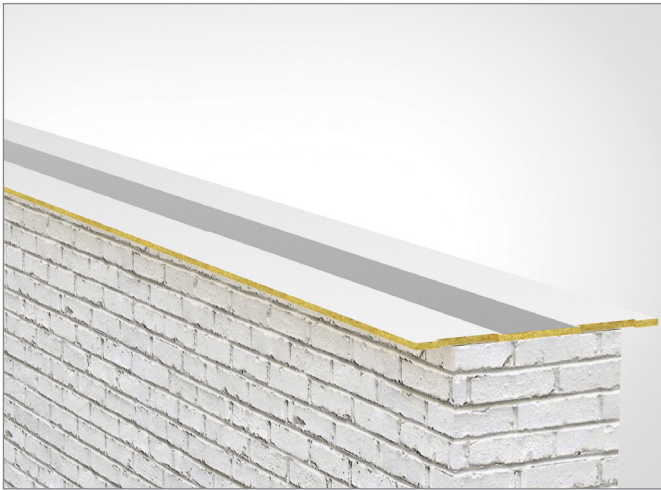

6. Precise cutting with a cutter

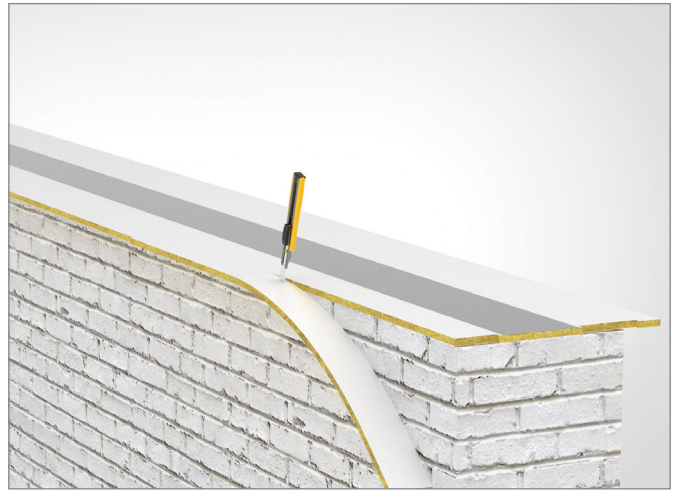

7. Concreting/placing the bearing on the masonry

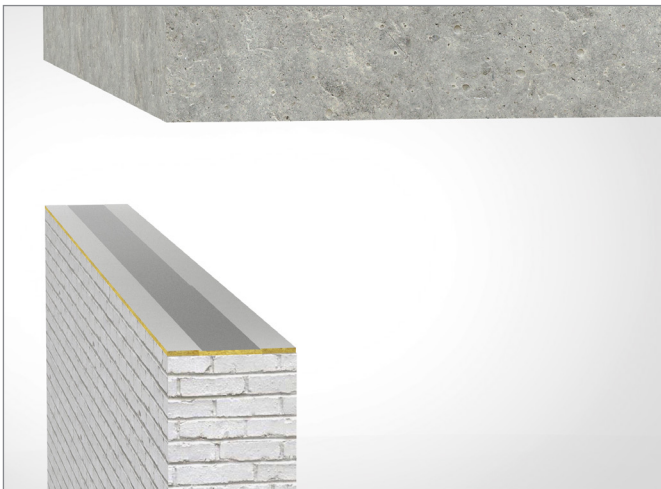

8. Completed installation

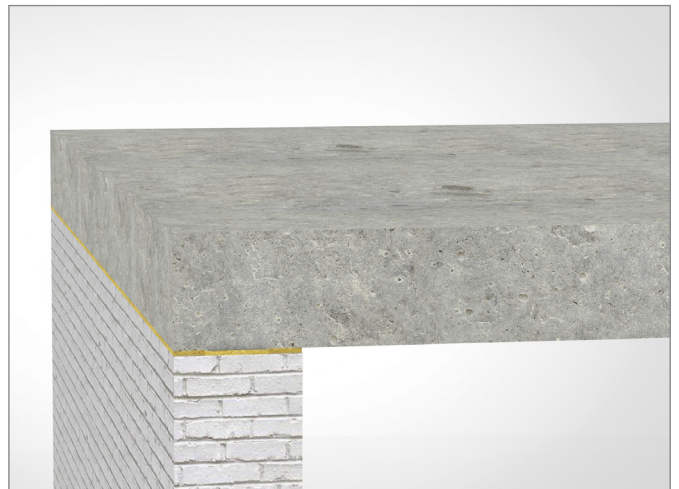



Calenberg Ingenieure GmbH
Am Knübel 2-4
31020 Salzhemmendorf | Germany

Tel. + 49 5153-9400-0
Fax + 49 5153-9400-49

info@calenberg-ingenieure.de
www.calenberg-ingenieure.com

A LISEGA Group Company



The contents of this publication are the result of many years' research and experience gained in application technology. All information and instructions are based on the best knowledge available to us; they do not represent a warranty of suitability for particular tasks nor do they exempt the user from conducting their own checks including verifying third-party property rights. No liability whatsoever will be accepted for damage arising from advice given in this publication, regardless of its nature or legal basis. We reserve the right to make technical modifications in the course of product development.